

• **Recommended condition of flow soldering**

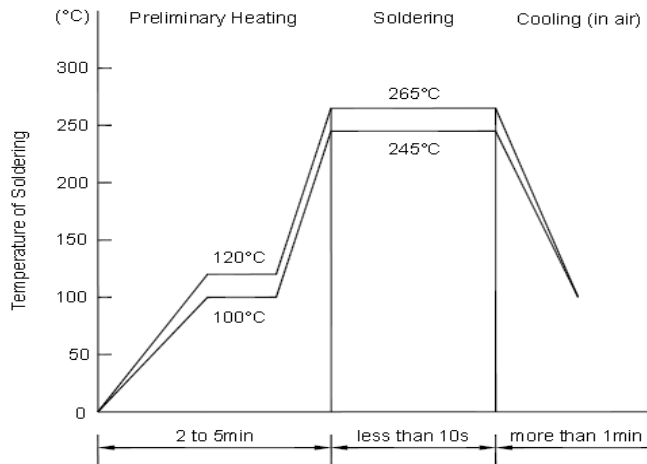

• **Recommended condition of reflow soldering**

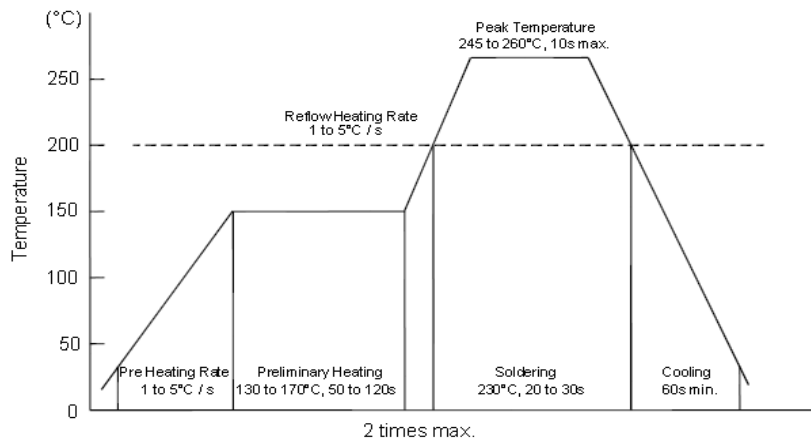

Recommended peak temperature is over 245 °C. If peak temperature is below 245 °C, you may adjust the following parameters; time length of peak temperature (longer), time length of soldering (longer), thickness of solder paste (thicker)

• **Condition of hand soldering**

Temperature: 370 °C

Time: 3 s max.

Times: one time

• **Remark:** Lead free solder paste (96.5Sn/3.0Ag/0.5Cu)

Units: in mm

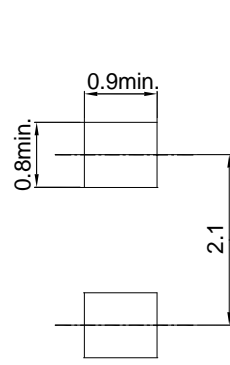

SOD-323

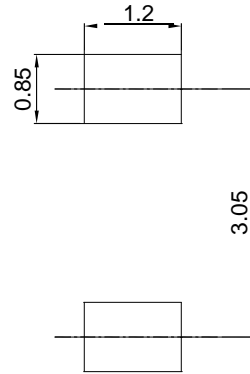

SOD-123

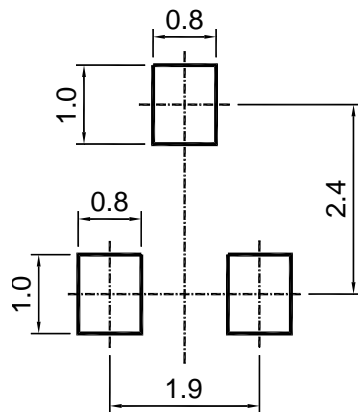

SOT-23

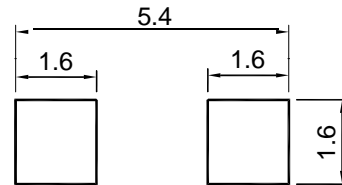

LL-34 (Mini MELF)